

MAKISHINKO
WORM TOP C-FACE HOLLOW SHAFT

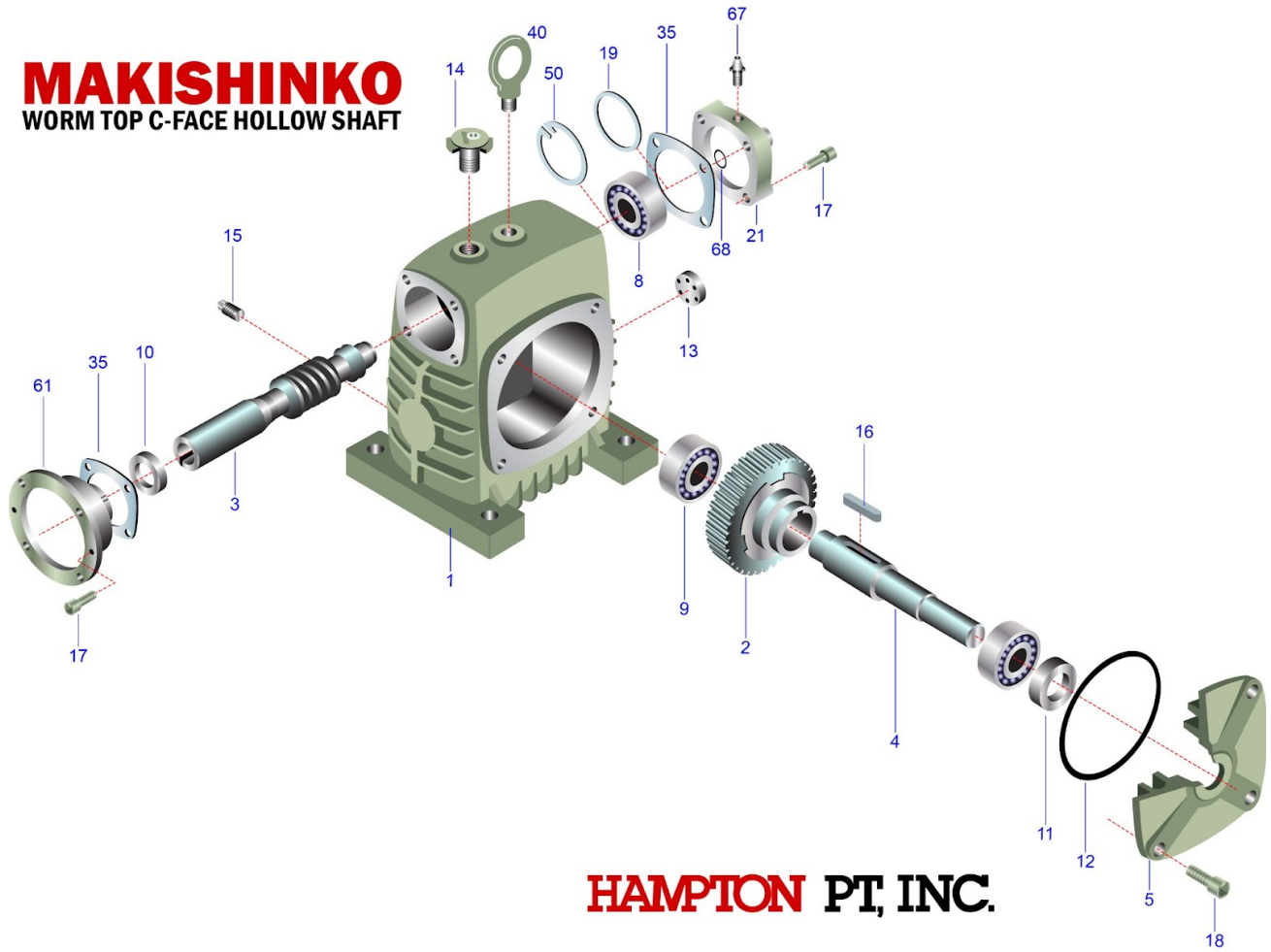

HAMPTON PT, INC.

Model - WTCHS

- | | | | |
|------------------------|---------------------------|------------------------|---------------------------|
| 1. Housing | 9. Bearing, Low Speed | 15. Oil Drain Plug | 35. High Speed Gasket |
| 2. Brass Gear | 10. Oil Seal, High Speed | 16. Key, LS Brass Gear | 40. Eyebolt (Sz. 100-135) |
| 3. Worm Input Shaft | 11. Oil Seal, Low Speed | 17. Cap Screw HS Cover | 50. Internal Snap Ring |
| 4. Output Shaft | 12. "O" Ring Seal | 18. Cap Screw LS Cover | 61. C-Face Motor Flange |
| 5. Cover, Low Speed | 13. Oil Level Gauge | 19. Shim, HS Cover | 67. Grease Fitting |
| 8. Bearing, High Speed | 14. Oil Fill/Breather Cap | 21. Cover, HS Closed | |

100 Polk Street, Eugene, OR 97402
Call Toll Free 1-888-211-0784 or (541) 393-0701 - Fax (541) 393-0704
www.Hampton-PT.com